



“Inspire Greatness”

Virtual Student & Parent Orientation

2021-2022 SCHOOL YEAR

WELCOME



- I. INTRODUCTIONS**
- II. REGISTRATION PROCESS**
- III. INSTRUCTIONAL DAY**
- IV. COVID SCREENING PROCESS**
- V. STUDENT EXPECTATIONS**
- VI. SOCIAL EMOTIONAL SUPPORT**
- VII. ATHLETICS**
- VIII. QUESTIONS & ANSWERS**

REGISTRATION PROCESS



1. Parents will need to complete the online registration process through Synergy ParentVue portal. Returning students will need to verify the information in the portal (Address, Immunizations, Lunch Application, Guardian Information, Health History)
2. Students will receive an email to their Google email with their appointment time and date by grade level.
3. All parents will need to have an email address on record for the 2021-2022 school year.

Parent portal info can be accessed <https://www.emuhsd.org/portalinfo>
Activation key for ParentVue will be provided to students at registration.



Registration Dates

Registration Time (By appointment only)

8:30 am - 12:00 pm

1:00 pm - 2:30 pm

- August 5 Seniors
- August 6 Juniors

August 9 Sophomores
August 10 Freshmen

Staff Lunch will take place from 12:00-1:00 pm

REGISTRATION DAY

Student Registration Day Traffic Flow

Station 1 Textbook Return – Textbook Room Gate

Station 2 Student Fines – Student Store

Station 3 Sales / Fast Pass– Activities Office

Station 4 Student ID's – ASB Room

Station 5 Computer Registration – BSSU Courtyard

Station 6 Attendance – BSSU

Station 7 Guidance – BSSU

Station 8 Health/Hazel Heath/Immunizations – BSSU

Station 9 Career Center/Dual Enrollment – BSSU

Station 10 Class Schedules w/Counselors – Media Center

Station 11 Chromebook/User Agreements – LEARN / Teen Center

Station 12 Textbook/ Class Schedule Pick-Up – Textbook Room

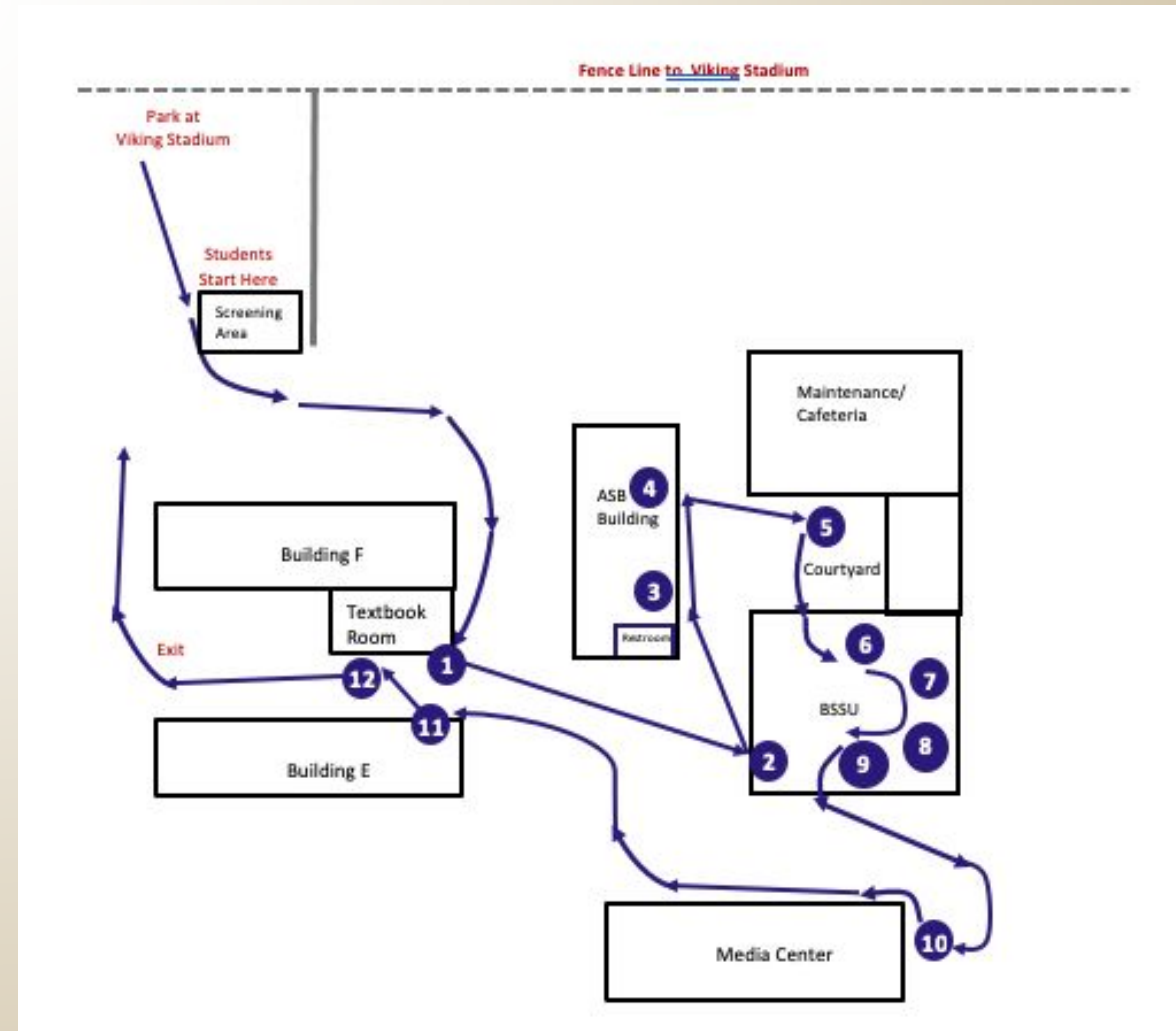

Academic Counselors

Ms. Claudia Autran (**A-EQU**) claudia.autran@emuhsd.org

626-443-6181 x 5850

Brenda Padron (**ER-LOP**) brenda.padron@emuhsd.org

626-443-6181 x 5851

Maria Palmieri (**LOQ-RAMN**) maria.palmieri@emuhsd.org

626-443-6181 x 5852

Janette Rodriguez (**RAMO-Z**) janette.rodriquez@emuhsd.org

626-443-6181 x 5853

Instructional Day

Block Schedule: Our Typical Day

BLOCK SCHEDULE

PURPLE DAYS	GOLD DAYS	SCHEDULE	MINUTES
PERIOD 0	PERIOD 0	7:30 – 8:21	(51)
PERIOD 1	PERIOD 2	8:30 - 10:06	96
Nutrition	Nutrition	10:06 - 10:18	(12)
Passing	Passing	10:18 - 10:23	5
PERIOD 3	PERIOD 4	10:23 - 12:01	98
Lunch	Lunch	12:01 - 12:38	(37)
Passing	Passing	12:38 - 12:43	5
SSR	SSR	12:43 - 12:58	15
PERIOD 5	PERIOD 6	12:58 - 2:34	96
Passing	Passing	2:34 - 2:39	5
PERIOD 7	PERIOD 7	2:39 - 3:30	51
Total Instructional Minutes			371

Instructional Day

Non-Block Days

NON-BLOCK SCHEDULE (5) - 8/17, 8/18, 12/13, 1/3, 5/27

PERIOD	SCHEDULE	MINUTES
PERIOD 0	7:30 – 8:21	(51)
PERIOD 1	8:30 – 9:19	49
Passing	9:19 – 9:24	5
PERIOD 2	9:24 – 10:13	49
Passing	10:13 – 10:18	5
PERIOD 3	10:18 – 11:07	49
Passing	11:07 – 11:12	5
PERIOD 4	11:12 – 12:01	49
Lunch	12:01 – 12:38	(37)
Passing	12:38 – 12:43	5
PERIOD 5	12:43 – 1:32	49
Passing	1:32 – 1:37	5
PERIOD 6	1:37 – 2:26	49
Passing	2:26 – 2:31	5
PERIOD 7	2:31 – 3:30	51
Total Instructional Minutes		375

*Our
schedule
for the first
2 days of
school!*

Instructional Day

Late - Start Schedule

LATE START SCHEDULE (15) – 8/30, 9/13, 10/4, 10/18, 11/8, 11/29, 12/6, 1/10, 2/7, 2/28, 3/14, 3/21, 4/4, 4/25, 5/16

PURPLE DAYS	GOLD DAYS	SCHEDULE	MINUTES
PERIOD 0	PERIOD 0	7:30 – 8:21	(51)
PERIOD 1	PERIOD 2	10:10 – 11:22	72
Passing	Passing	11:22 – 11:27	5
PERIOD 3	PERIOD 4	11:27 – 12:39	72
Lunch	Lunch	12:39 – 1:16	(37)
Passing	Passing	1:16 – 1:21	5
PERIOD 5	PERIOD 6	1:21 – 2:33	72
Passing	Passing	2:33 – 2:39	6
PERIOD 7	PERIOD 7	2:39 – 3:30	51
Total Instructional Minutes			283

Independent Study Option

To enroll in an independent Study program, a parent or guardian must submit an Independent Study Application for the student.

More information on the EMUHSD Independent Study Program can be found at: bit.ly/emuhstdis

COVID Screening Process

Fast Pass

Students who have been fully vaccinated against COVID-19 may present proof of vaccination to their school in order to receive a fast pass emblem on their student ID card. This Fast-Pass emblem will allow students to skip the daily screening and temperature taking needed to enter campus. Qualifying students who are medically eligible are encouraged to present proof of COVID-19 vaccination to their school as soon as possible. Students who presented proof of vaccination during the summer will not need to submit proof once again.

COVID-19 At-Home Screening

Students who do not receive the fast pass emblem on their student ID card will be required to complete a daily at-home COVID-19 screener. This screener will be available on student chromebooks. Once the screener is completed, it will email students a daily pass that will be used to enter campus. This daily pass must be presented upon entering campus. In order to expedite campus entry, students should complete the at home screener before leaving their home every morning. This option requires temperature taking which will occur randomly at predetermined time intervals.

COVID-19 In-Person Screening

Students who are not fully vaccinated, or who do not complete the daily COVID-19 at-home screener, or who lost a fast pass ID, or who cannot present a daily pass will be required to participate in COVID-19 in-person screening at the school gate. This option also requires temperature taking which will occur randomly at predetermined time intervals.

EMUHSD will continue to monitor guidance from the Los Angeles County Department of Public Health and will make adjustments as needed. We thank you for your cooperation and support and encourage all qualifying students to obtain a fast pass emblem as soon as possible. Please contact your local high school for additional information as needed.

Student Expectations

- Be on time daily, positive daily attendance promotes student success, Chronic absenteeism must be avoided.
- Student must wear face coverings on campus.
- All students are assigned a Chromebook, Chromebook and charger should be brought to school daily.
- Students should come prepared to school backpack, school supplies
- Dress code enforced
- All students must present a note, phone call for absences
- Check your school issued Google email daily
- Student Mental Health is a priority
- Students must have a school issued ID at all times

Social Emotional Support

MVHS is introducing our new **Wellness Center** available for all students.

The Wellness Center will be staffed by:

- The Comprehensive Student Support Coordinator: Francisco Zamarripa
- Licensed Marriage and Family Counselor: Daniela Chavez
- Azusa Pacific University MFT Interns



Wellness Center Services:

Hours: 8:30 am to 3:30 pm

- Peer Support Program and Services
- Prevention and Self-Help Resources
- Self-Care/Meditation Break Area
- Scheduled Wellness Support Services
 - Behavioral Support Workshops
 - Growth/Interest Groups
 - Individual and Group Counseling Services - partially
 - Wellness Related Workshops

Athletics

Join Football, Volleyball, Band, Cross Country, and more!

Clearance Process

- Get cleared online at our Athletics website:

<https://www.emuhsd.org/domain/264>

- Must provide an updated physical & signed waivers before being allowed to participate in practice.

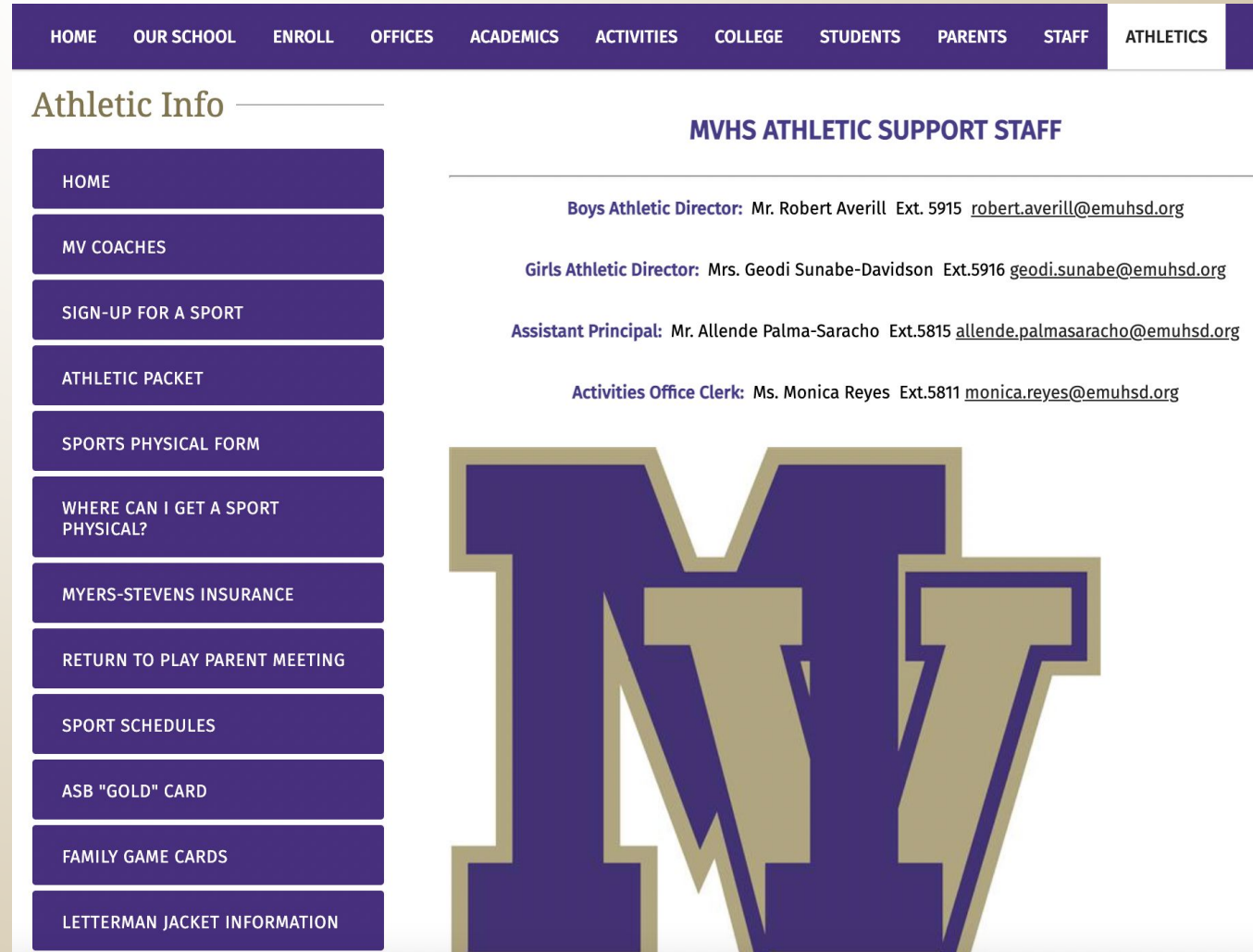

The screenshot shows the Athletics page of the MVHS website. At the top is a dark purple navigation bar with white text for: HOME, OUR SCHOOL, ENROLL, OFFICES, ACADEMICS, ACTIVITIES, COLLEGE, STUDENTS, PARENTS, STAFF, and ATHLETICS. Below the navigation bar is a white section titled "Athletic Info" with a list of purple buttons containing the following text: HOME, MV COACHES, SIGN-UP FOR A SPORT, ATHLETIC PACKET, SPORTS PHYSICAL FORM, WHERE CAN I GET A SPORT PHYSICAL?, MYERS-STEVENS INSURANCE, RETURN TO PLAY PARENT MEETING, SPORT SCHEDULES, ASB "GOLD" CARD, FAMILY GAME CARDS, and LETTERMAN JACKET INFORMATION. To the right of this menu is a white section titled "MVHS ATHLETIC SUPPORT STAFF" with a list of staff members and their contact information: Boys Athletic Director: Mr. Robert Averill Ext. 5915 robert.averill@emuhsd.org; Girls Athletic Director: Mrs. Geodi Sunabe-Davidson Ext.5916 geodi.sunabe@emuhsd.org; Assistant Principal: Mr. Allende Palma-Saracho Ext.5815 allende.palmasaracho@emuhsd.org; and Activities Office Clerk: Ms. Monica Reyes Ext.5811 monica.reyes@emuhsd.org. At the bottom right of the screenshot is a large, stylized "MV" logo in purple and gold.

Question & Answer

The background is a light beige gradient. In the top-left and bottom-right corners, there are several realistic-looking water droplets of various sizes, some overlapping. The droplets have highlights and shadows, giving them a three-dimensional appearance.

Thank you!